



#### IMPORTANT SAFETY PRECAUTIONS

**Before you begin, read these instructions completely and carefully.**

- Be certain electrical power is OFF before and during installation, maintenance and removal.
- Luminaire wiring must be properly grounded in accordance with the NEC and any applicable local code requirements.
- Use only UL or IEC approved wire for input/output connections.
- Verify that supply voltage matches voltage on luminaire label. Installation to any other connection may void the warranty.
- Wear gloves during installation to prevent injury and do not expose wiring to metal or sharp edges.
- Do not install in areas subject to combustible vapors or gases. Verify luminaire location ratings are suitable for installation environment (refer to specification sheet as needed).
- Do not restrict luminaire's ventilation by covering with material that will cause luminaire to overheat and potentially shorten the life span.
- Ensure LED luminaire has the correct polarity before installation.



**WARNING:** To reduce the risk of personal injury or property damage from fire, electrical shock, falling parts, abrasions, burns and all other hazards, read all provided warnings and follow installation instructions.

This product should be installed, inspected and maintained by a qualified and licensed electrician. Installation of luminaire must be in accordance with NEC and local code requirements.

**SAVE THESE INSTRUCTIONS**



TOOLS REQUIRED



LADDER



SAFETY GLASSES



ELECTRICAL TAPE

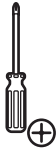

PHILLIPS SCREWDRIVER



FLAT BLADE SCREWDRIVER



PLIERS



WIRE STRIPPERS

HARDWARE INCLUDED



NOTE: Hardware not shown to actual size.

PART	DESCRIPTION	QUANTITY
AA	Mounting bracket	1
BB	Mounting screw	2
CC	Wire nut	3
DD	Cap nut	2
EE	Washer	2



AA



BB



CC



DD



EE

PRE-INSTALLATION

PLANNING INSTALLATION

- ☐ Read all instructions before installation.
- ☐ To avoid damaging this product, assemble it on a soft, non-abrasive surface, such as carpet or cardboard.
- ☐ Keep your receipt and these instructions for proof of purchase.

PACKAGE CONTENTS

PART	DESCRIPTION	QUANTITY
A	Light fixture	1

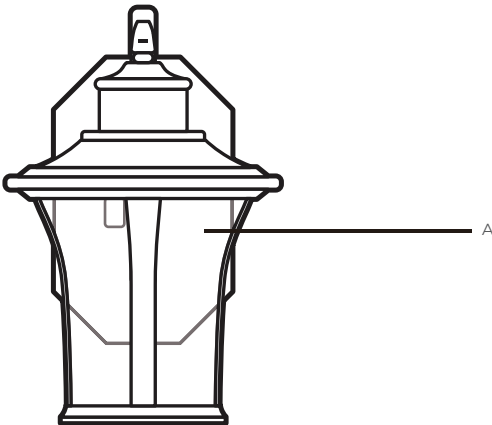

SAVE THESE INSTRUCTIONS

## INSTALLATION

### 1) ATTACHING THE MOUNTING UNIT TO THE OUTLET BOX

- ☐ Remove the pre-assembled cap nuts (DD) and washers (EE) from the mounting unit (AA).
- ☐ Screw the mounting screws (BB) through the holes on the mounting unit (AA) into the screw holes on the outlet box.



**NOTE:** The preinstalled support screw on the mounting unit (AA) should protrude out away from the outlet box.

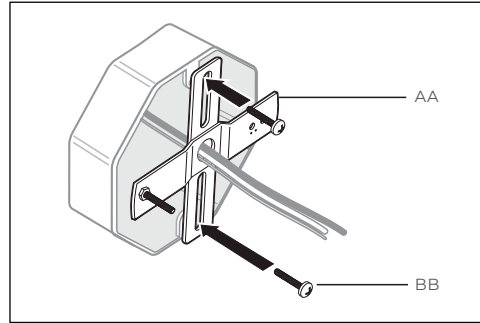

### 2) MAKING THE ELECTRICAL CONNECTIONS

- ☐ Connect the copper wire from the light fixture (A) to the mounting unit (AA) by securing it with the pre-installed ground screw.
- ☐ Connect the black wire from the fixture to the black wire from the outlet box, the white wire from the fixture to the white wire from the outlet box, and the copper wire from the fixture to the ground wire from the outlet box with the wire nuts (CC). Secure with electrical tape (not included).



**NOTE:** If the wires from the fixture are the same color, attach the side with markings or letters to the black (positive) wire and the other to the white (neutral) wire.

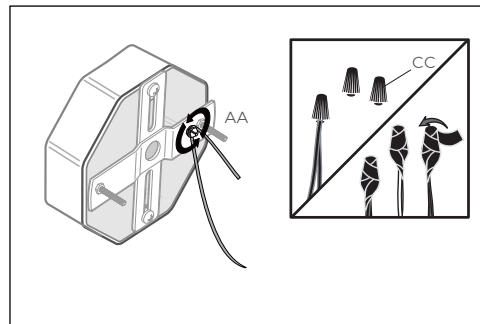

### 3) SECURING THE LIGHT FIXTURE

- ☐ After wires are connected, tuck them carefully inside the junction box.
- ☐ Remove the two preinstalled nuts and washers from the light fixture (A) and remove the shade.
- ☐ Discard the prepackaged cardboard and reinstall the shade using the previously removed nuts and washers.
- ☐ Secure the light fixture (A) to the junction box by placing it over the pre-installed screws on the mounting bracket (AA) and securing it with the washers (EE) and cap nuts (DD).



**CAUTION:** To avoid any waterproofing problems, make sure the light fixture fits the mounting surface perfectly during installation and use waterproof glue (not included) around the canopy for better sealing after installation.

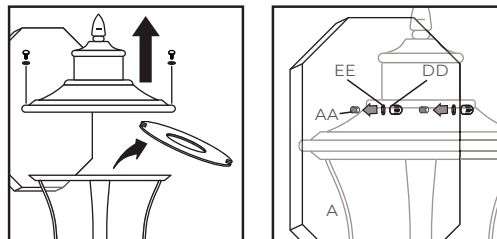

## OPERATION

### 1) TURNING THE LIGHT ON

- ☐ Turn the light switch on to activate the fixture.
- ☐ If it is daylight, the fixture will not illuminate. To test the fixture, cover the photocell with electrical tape. Once you confirm the fixture illuminates, remove the electrical tape.
- ☐ If it is daylight, the fixture may not illuminate with the electrical tape over the photocell, as the photocell can be sensitive. Wait until nighttime to confirm the fixture illuminates.



**NOTE:** Position the photocell fixture so that the light from the any other fixture or any other light does not shine directly onto the "eye," as this will interfere with the normal operation of the photocell fixture.

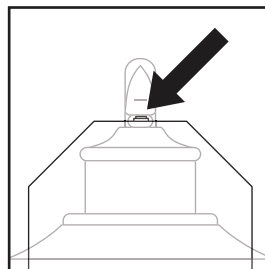

**SAVE THESE INSTRUCTIONS**



## TROUBLESHOOTING

PROBLEM	POSSIBLE CAUSE	SOLUTION
The bulb will not light.	The bulb is burned out.	Replace the light bulb.
	The power is off.	Ensure the power supply is On.
	There is a faulty wire connection.	Check the wiring.
	The circuit breaker is off.	Ensure the circuit breaker is in the On position.
The fuse blows or circuit breaker trips when the light is turned on.	There are crossed wires or the power wire is grounding out.	Check the wire connections. Contact a qualified electrician.

**SAVE THESE INSTRUCTIONS**

