



IMPORTANT SAFETY PRECAUTIONS

Before you begin, read these instructions completely and carefully.

- Be certain electrical power is OFF before and during installation, maintenance and removal.
- Luminaire wiring must be properly grounded in accordance with the NEC and any applicable local code requirements.
- Use only UL or IEC approved wire for input/output connections.
- Verify that supply voltage matches voltage on luminaire label. Installation to any other connection may void the warranty.
- Wear gloves during installation to prevent injury and do not expose wiring to metal or sharp edges.
- Do not install in areas subject to combustible vapors or gases. Verify luminaire location ratings are suitable for installation environment (refer to specification sheet as needed).
- Do not restrict luminaire's ventilation by covering with material that will cause luminaire to overheat and potentially shorten the life span.
- Ensure LED luminaire has the correct polarity before installation.



WARNING: To reduce the risk of personal injury or property damage from fire, electrical shock, falling parts, abrasions, burns and all other hazards, read all provided warnings and follow installation instructions.

This product should be installed, inspected and maintained by a qualified and licensed electrician. Installation of luminaire must be in accordance with NEC and local code requirements.

SAVE THESE INSTRUCTIONS

INSTALLATION INSTRUCTIONS

A) Press the oval buckles to release the backplate.

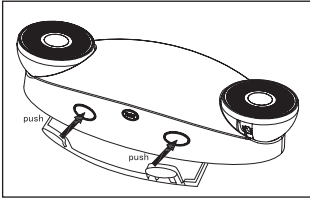

B) Cut open the central hole on the backplate to cross through the power wires of the external circuit.

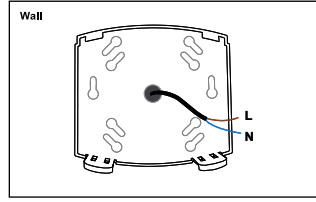

C) Use expansion screws and steel screws to install the backplate on the wall.

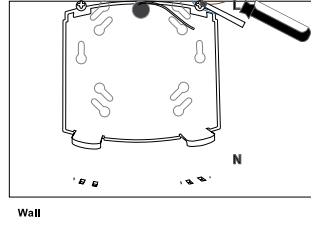

D) Turn off the external circuit to prepare the power wires connection.

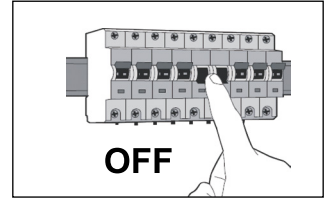

E) Use wire connectors to connect corresponding wire with external circuit:

- White wire is connected with neutral Line;
- Black wire (120V) or red wire (277V) is connected with Live Line according to the voltage.

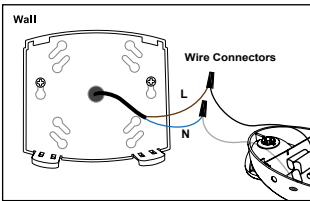

F) Connect battery line with the terminal "BATT" on PCB. Turn on the external circuit.

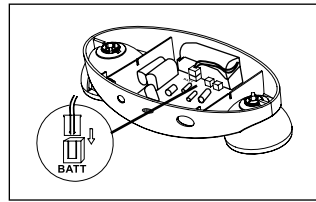

G) Press the "TEST" button to simulate outage effect to test the illumination of lamp.

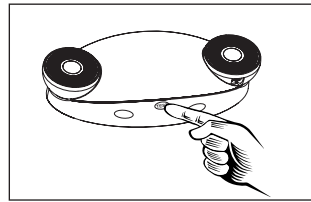

H) Fix the lamp body on the backplate. Installation is finished.

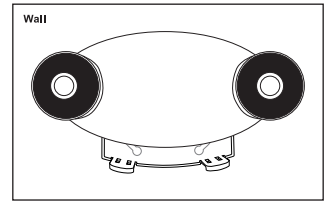

LAMP AND ACCESSORIES INCLUDED IN PACKAGE

1X LED Lamp, 2X Steel Screws, 2X Expansion Screws, 3X Wire Connectors

OPERATION

- When the power failure occurs, the lamp turns on automatically and illuminates for at least 90 minutes.
- When the power electricity is recovered, the lamp turns off and starts to charge automatically.
- We recommend periodic lighting tests on this lamp every month by pressing the "TEST" button. The "TEST" button is used to simulate outage effect.

BATTERY REPLACEMENT

The battery replacement time is the recommended time according to UL requirements. The batter can continue to be charged and discharged normally after the marked time.

ELECTRICAL CONNECTIONS

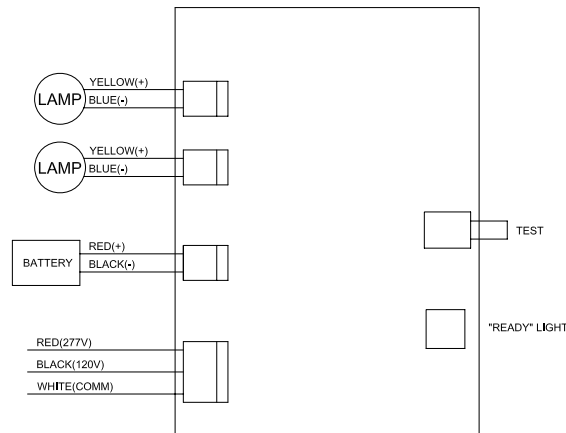

SAVE THESE INSTRUCTIONS