



IMPORTANT SAFETY PRECAUTIONS

Before you begin, read these instructions completely and carefully.

- Be certain electrical power is OFF before and during installation, maintenance and removal.
- Luminaire wiring must be properly grounded in accordance with the NEC and any applicable local code requirements.
- Use only UL or IEC approved wire for input/output connections.
- Verify that supply voltage matches voltage on luminaire label. Installation to any other connection may void the warranty.
- Wear gloves during installation to prevent injury and do not expose wiring to metal or sharp edges.
- Do not install in areas subject to combustible vapors or gases. Verify luminaire location ratings are suitable for installation environment (refer to specification sheet as needed).
- Do not restrict luminaire's ventilation by covering with material that will cause luminaire to overheat and potentially shorten the life span.
- Ensure LED luminaire has the correct polarity before installation.



WARNING: To reduce the risk of personal injury or property damage from fire, electrical shock, falling parts, abrasions, burns and all other hazards, read all provided warnings and follow installation instructions.

This product should be installed, inspected and maintained by a qualified and licensed electrician. Installation of luminaire must be in accordance with NEC and local code requirements.

SAVE THESE INSTRUCTIONS



DIMENSIONS

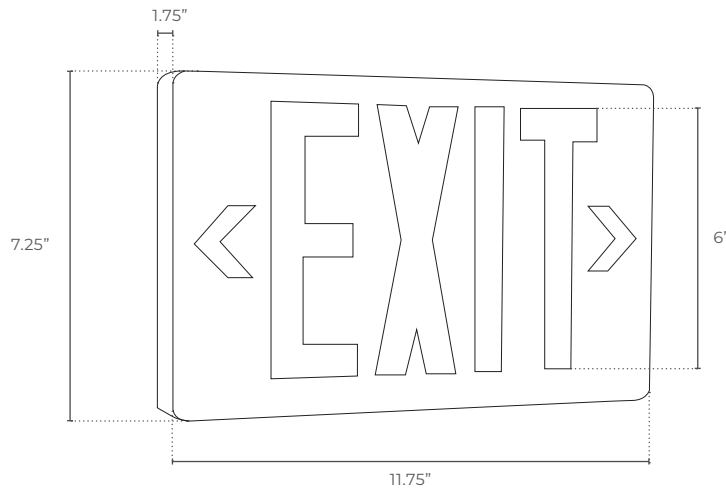

Mounting Canopy

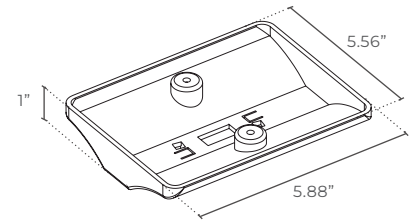

MOUNTING TYPE

Wall Mount



Side Mount

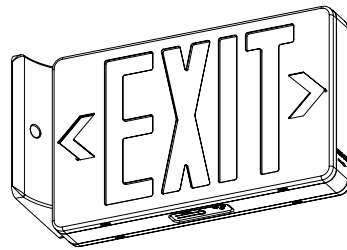

Ceiling Mount

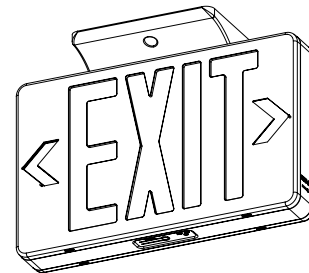

ELECTRICAL CONNECTIONS

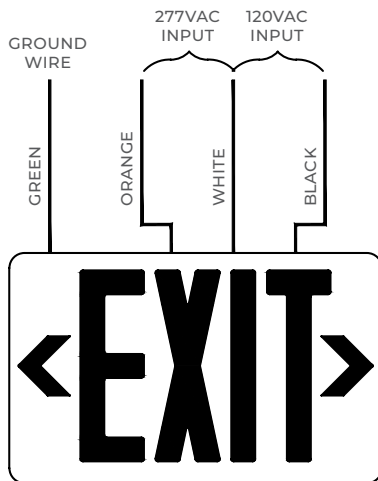

PART DESCRIPTIONS

- 1) Plastic housing
- 2) EXIT panel
- 3) Back plate
- 4) Mounting hole cover
- 5) Snap in directional arrow
- 6) Red or green diffuser
- 7) Canopy
- 8) Canopy screws
- 9) Wire nuts
- 10) Junction box (building utility)
- 11) Crossbar
- 12) Crossbar screws (not provided)

CAUTION

Battery connector is shipped disconnected. It must be connected at installation.
AC only item no battery backup.

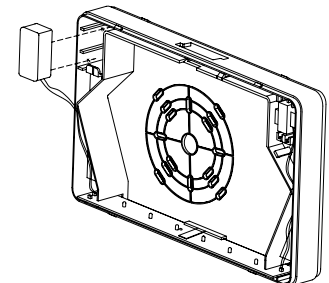

SAVE THESE INSTRUCTIONS



INSTALLATION INSTRUCTIONS (WALL MOUNT)

- A)** Drill $\frac{1}{4}$ " holes into oblong knock outs on back plate (3) that correspond to junction box (10) holes to be used.
- B)** Feed the transformer input leads through center hole and make the proper connections. If using 120VAC, connect the black and white leads to the building utility. If using 277VAC, connect the orange and white leads to the building utility. Cap off unused wire. If the unit is self-powered, be sure to snap battery connector together.
- C)** Feed excess wire into junction box and secure back plate (3) to junction box (10).
- D)** Snap in arrows (5) on EXIT panel (2) as required. Then snap EXIT panel (2) to housing, top first and then bottom.

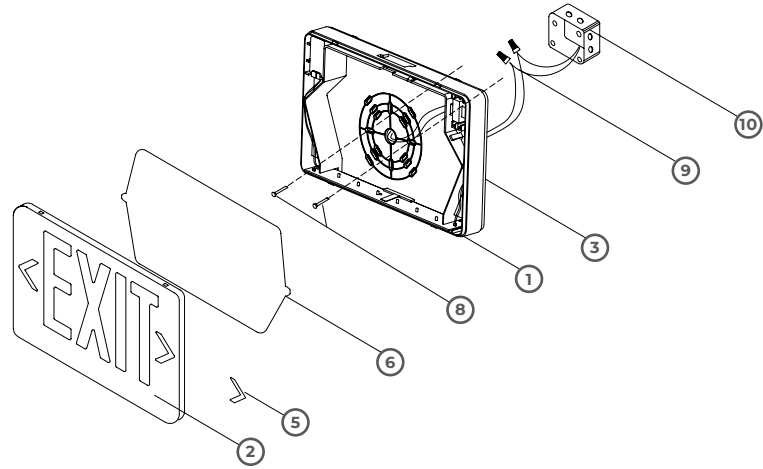

INSTALLATION INSTRUCTIONS (SIDE MOUNT)

- A)** Attach crossbar (11) to junction box (10). Set the crossbar so that the longer blade is touching the junction box.
- B)** Open the EXIT housing. Feed the transformer input leads through side hole, being sure to secure wire into wire guides molded at the edges of the sign.
- C)** Attach sign to canopy (7) by inserting canopy into sign at an angle, then twist to secure.
- D)** Make the proper supply lead connections. If using 120VAC, connect the black and white leads to the building utility. If using 277VAC, connect the orange and white leads to the building utility. Cap off unused wire. If the unit is self-powered, be sure to snap battery connector together.
- E)** Push excess wire into junction box and align holes in canopy (7) with those in crossbar (11). Using screws supplied, tighten canopy to crossbar so that canopy is securely fastened and tight against wall.
- F)** Snap in arrows (5) to EXIT panel (2) as required. Then snap EXIT panel (2) to housing, top first and then bottom.

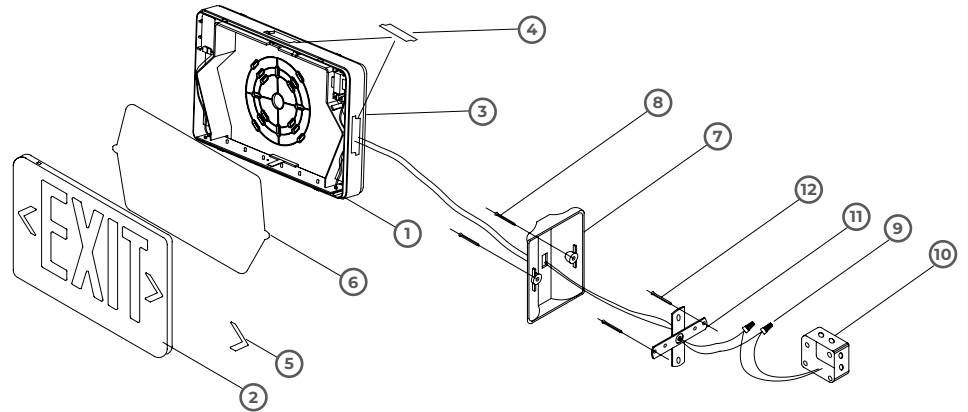

ASSEMBLING CANOPY TO HOUSING

Insert canopy into housing at a 20 degree angle and twist. Quick snap is now firmly locked.

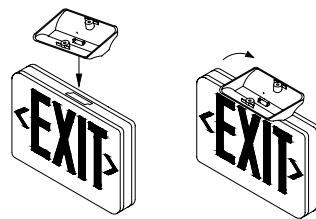

CAUTION: Trying to remove canopy after it is locked in place may cause damage.

OPENING EXIT PANEL

Use flat blade screwdriver to open. Insert screwdriver into the slot and gently pry off the panel.

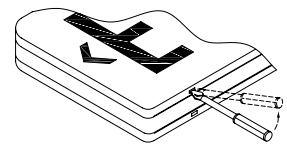

SAVE THESE INSTRUCTIONS



INSTALLATION INSTRUCTIONS (CEILING MOUNT)

A) Attach crossbar (11) to junction box (10). Set the crossbar so that the longer blade is touching the junction box.

B) Open the EXIT housing. Feed the transformer input leads through top hole, being sure to secure wire into wire guides molded at the edges of the sign.

C) Attach sign to canopy by inserting canopy into sign at an angle, then twist to secure.

D) Make the proper supply lead connections. If using 120VAC, connect the black and white leads to the building utility. If using 277VAC, connect the orange and white leads to the building utility. Cap off unused wire. If the unit is self-powered, be sure to snap battery connector together.

E) Push excess wire into junction box and align holes in canopy (7) with those in crossbar (11). Using screws supplied, tighten canopy to crossbar so that canopy is securely fastened and tight against ceiling.

F) Snap in arrows (5) to EXIT panel (2) as required. Then snap EXIT panel (2) to housing, top first and then bottom.

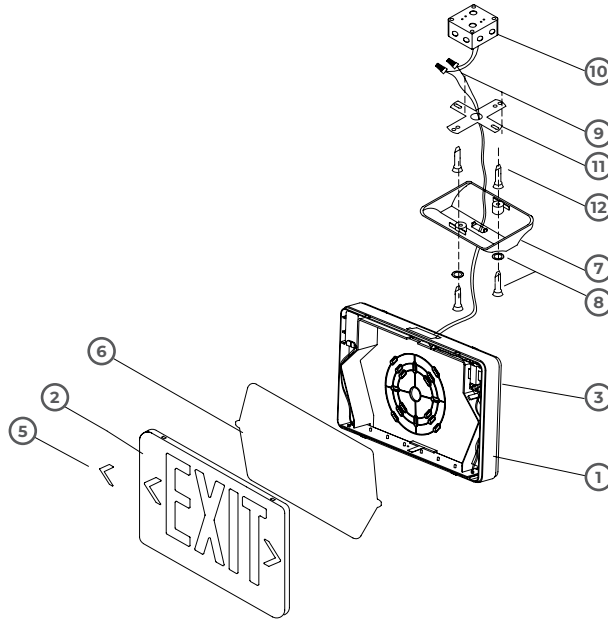

ASSEMBLING CANOPY TO HOUSING

Insert canopy into housing at a 20 degree angle and twist. Quick snap is now firmly locked.

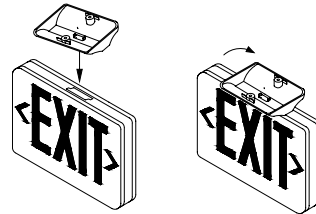

CAUTION: Trying to remove canopy after it is locked in place may cause damage.

OPENING EXIT PANEL

Use flat blade screwdriver to open. Insert screwdriver into the slot and gently pry off the panel.

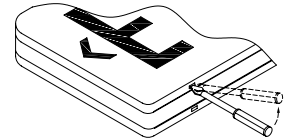

MAINTENANCE (FOR BATTERY BACKUP)

Battery has to recharge if product was kept in stock for over 9 months, detail manual refer "BATTERY STOCK AND RECHARGE GUIDELINE."

We recommend that the equipment be tested regularly in accordance with local codes. Replace the batteries as needed if discharge time do not achieve 90 minutes.

OPERATION (FOR BATTERY BACKUP)

Press the test button, unit illuminance by battery backup and the LED indicator will turn off, release the test switch, LED indicator will turn on and the LED heads will turn off.

MANUAL TESTING

- 1) Manual test switch
- 2) LED indicator (indicates normal operation)

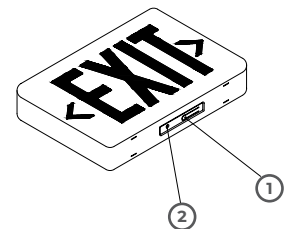

SAVE THESE INSTRUCTIONS

