

IMPORTANT SAFETY PRECAUTIONS

Before you begin, read these instructions completely and carefully.

- Be certain electrical power is OFF before and during installation, maintenance and removal.
- Luminaire wiring must be properly grounded in accordance with the NEC and any applicable local code requirements.
- Use only UL or IEC approved wire for input/output connections.
- Verify that supply voltage matches voltage on luminaire label. Installation to any other connection may void the warranty.
- Wear gloves during installation to prevent injury and do not expose wiring to metal or sharp edges.
- Do not install in areas subject to combustible vapors or gases. Verify luminaire location ratings are suitable for installation environment (refer to specification sheet as needed).
- Do not restrict luminaire's ventilation by covering with material that will cause luminaire to overheat and potentially shorten the life span.
- Ensure LED luminaire has the correct polarity before installation.



WARNING: To reduce the risk of personal injury or property damage from fire, electrical shock, falling parts, abrasions, burns and all other hazards, read all provided warnings and follow installation instructions.

This product should be installed, inspected and maintained by a qualified and licensed electrician. Installation of luminaire must be in accordance with NEC and local code requirements.

SAVE THESE INSTRUCTIONS

DIMENSIONS

1 X 4

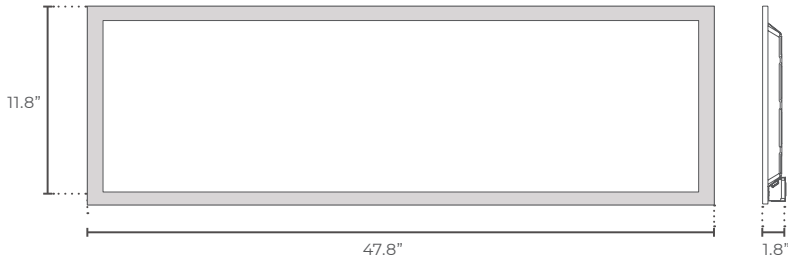

2 X 2

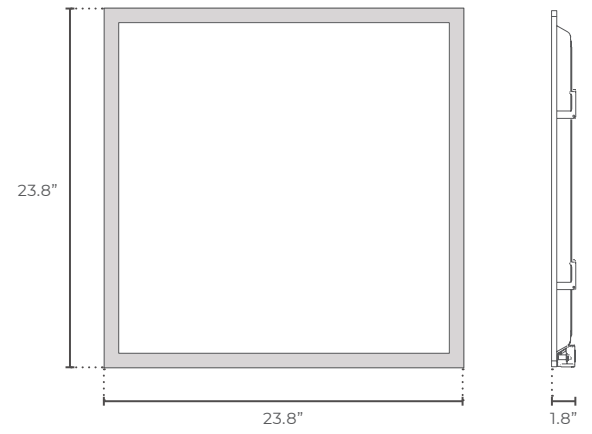

2 X 4

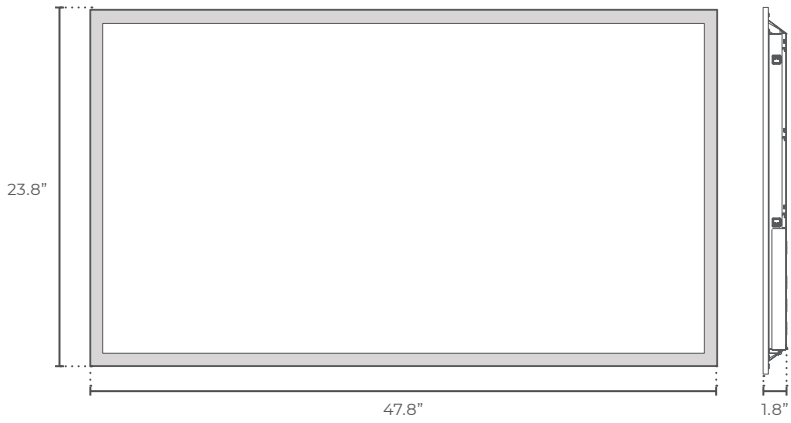

MOUNTING TYPE

Recessed Mount

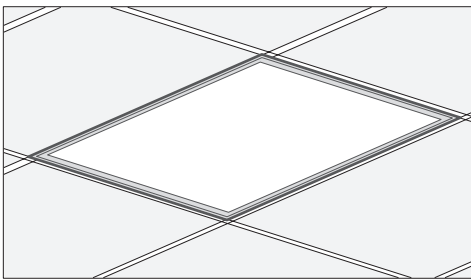

Surface Mount

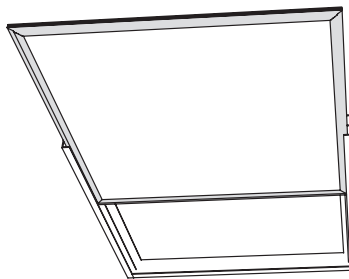

Suspended Mount

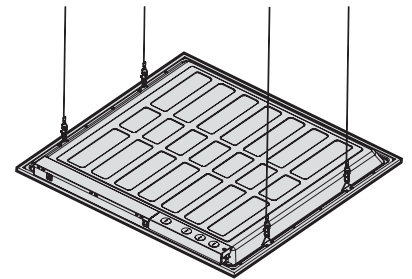

SAVE THESE INSTRUCTIONS

RECESSED GRID MOUNT INSTRUCTIONS

A) Take the panel out of the box and protective bag and remove the protective film.

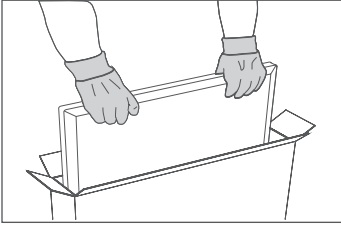

B) Lift the mounting clip on the edge of the panel.

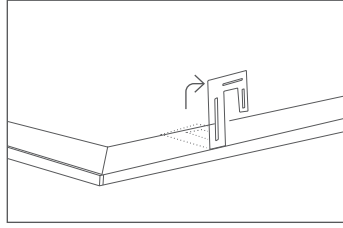

C) Turn the mounting clip head.

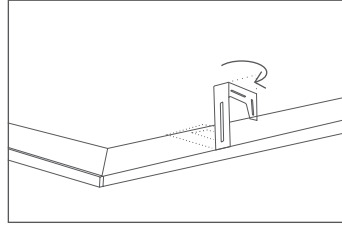

D) Put the panel into the grid ceiling.

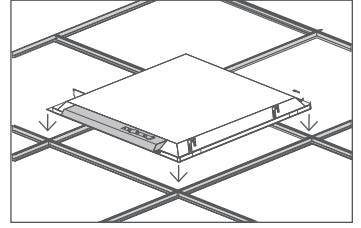

E) Attach mounting clips to the T-Bar of the ceiling grid.

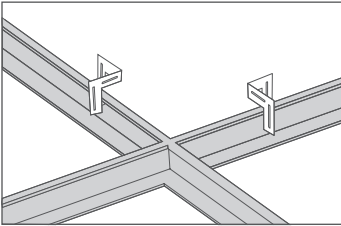

F) Remove the driver box cover.

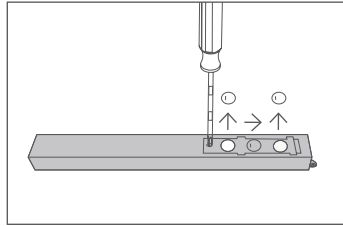

G) Open the knockout hole.

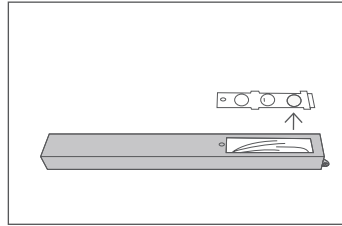

H) Insert the cable into the driver box.

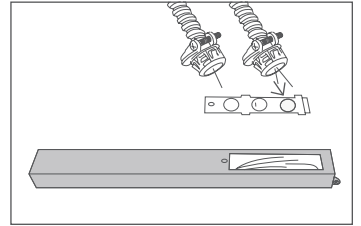

I) Connect the AC main power and 1-10V dimming cable to the LED driver.

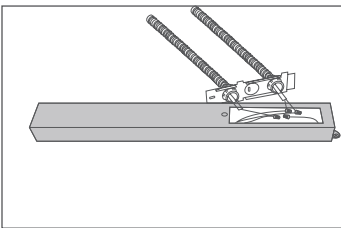

J) Insert the driver box on the right side of the cover and then slide it to the left to hold the cover.

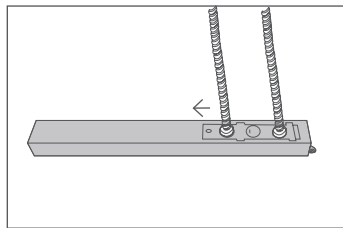

K) Screw the driver cover back.

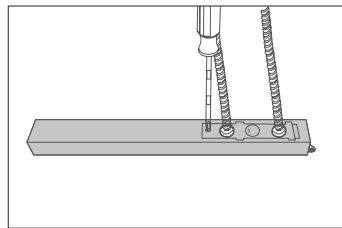

L) Complete.

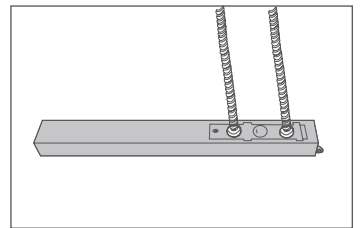

SAVE THESE INSTRUCTIONS

SURFACE MOUNT INSTALLATION

A) Take 2 boards and insert the 4 clips. Assemble the boards to form the frame.

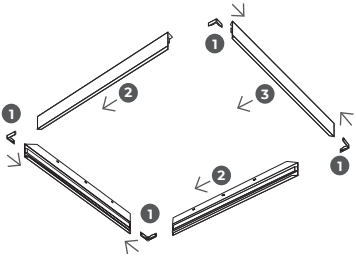

B) Fix to the ceiling.

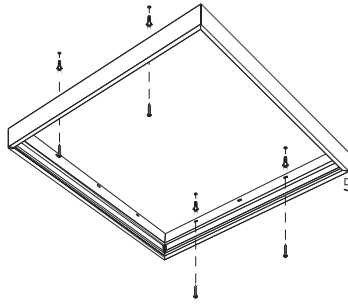

C) Once securely mounted to the ceiling, disassemble one end.

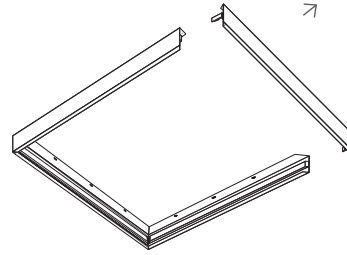

D) Slide the panel into the frame channel.

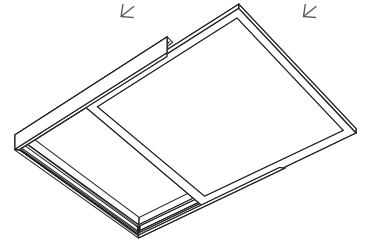

E) Reassemble the remaining end.

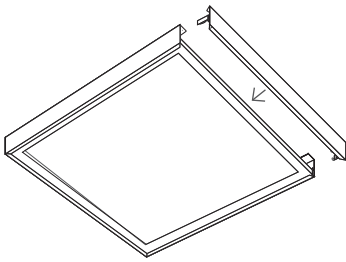

E) Complete.

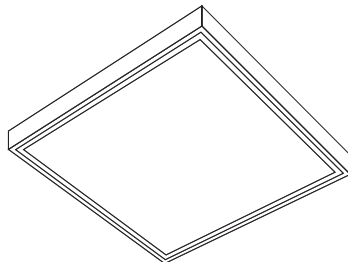

SUSPENDED MOUNT INSTALLATION

A) Based on the length of the panel, drill two mounting holes on the mounting plane. (2 holes for 2-cable kit and 4 holes for 40-cable kit).

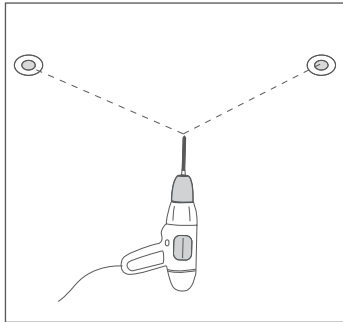

B) Fix upper cover to mounting hole.

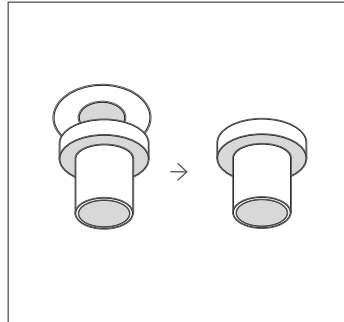

C) Insert Screw B into the Expansion Bolt to create self-tapping screw.

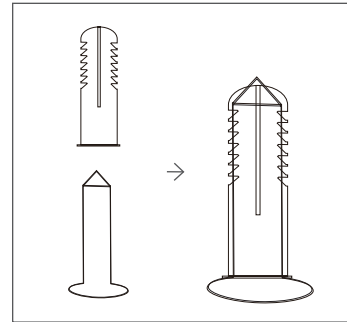

D) Use the self-tapping screw to secure the upper cover to the mounting hole.

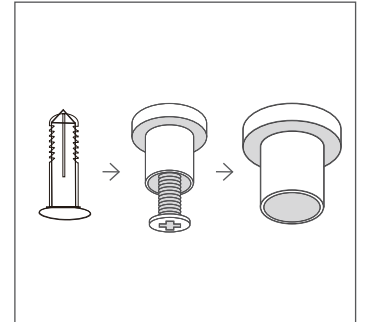

E) Screw the lower cover into the upper cover. Connect the wires with suspension hooks to the lower covers.

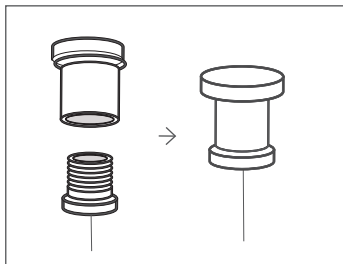

F) Replace earthquake clips with triangle brackets (use existing screws to secure).

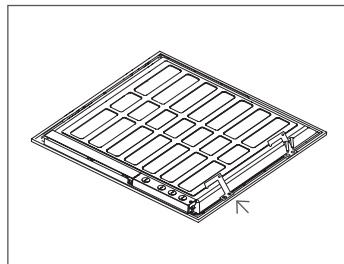

G) Release wire and attach suspensions hooks to triangle brackets. Adjust wires to desired length.

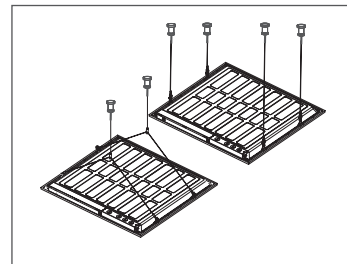

SAVE THESE INSTRUCTIONS