



## IMPORTANT SAFETY PRECAUTIONS

**Before you begin, read these instructions completely and carefully.**

- Be certain electrical power is OFF before and during installation, maintenance and removal.
- Luminaire wiring must be properly grounded in accordance with the NEC and any applicable local code requirements.
- Use only UL or IEC approved wire for input/output connections.
- Verify that supply voltage matches voltage on luminaire label. Installation to any other connection may void the warranty.
- Wear gloves during installation to prevent injury and do not expose wiring to metal or sharp edges.
- Do not install in areas subject to combustible vapors or gases. Verify luminaire location ratings are suitable for installation environment (refer to specification sheet as needed).
- Do not restrict luminaire's ventilation by covering with material that will cause luminaire to overheat and potentially shorten the life span.
- Ensure LED luminaire has the correct polarity before installation.



**WARNING:** To reduce the risk of personal injury or property damage from fire, electrical shock, falling parts, abrasions, burns and all other hazards, read all provided warnings and follow installation instructions.

This product should be installed, inspected and maintained by a qualified and licensed electrician. Installation of luminaire must be in accordance with NEC and local code requirements.

**SAVE THESE INSTRUCTIONS**

**INSTALLATION INSTRUCTIONS**

**A)** Loosen wing nut inside can, slide socket bracket completely up and tighten wing nut.

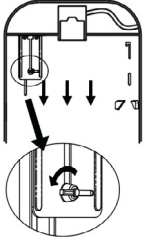

**B)** Screw Socket Adapter into existing can socket

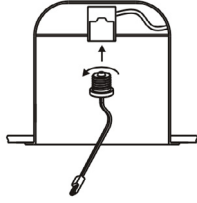

**C)** Plug female connector of fixture into male connector of socket adapter assembly.

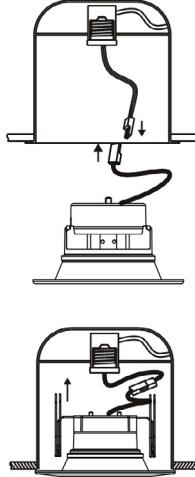

**D) (For 4" Retrofit)** Squeeze friction blades to engage. Tuck all wires into can and carefully push retrofit trim into can. To provide enough room in shallow cans, carefully position socket adapter wiring to side of LED driver prior to inserting retrofit trim into the can.

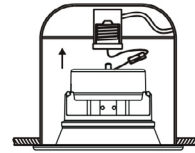

**E) (For 5" /6" Retrofit)** Squeeze both torsion spring arms together and insert into torsion spring slots (or receiver brackets) of can

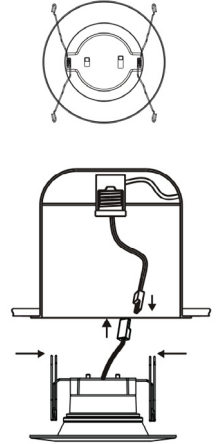

**REMOVING LED LUMINAIRES**

- A)** Pull down firmly on trim ring until fixture stops.
- B)** Squeeze torsion springs together to remove LED fixture.
- C)** Disconnect Fixture from socket adapter.
- D)** Unscrew socket adapter from recessed can.

**CCT & POWER ADJUSTMENT**

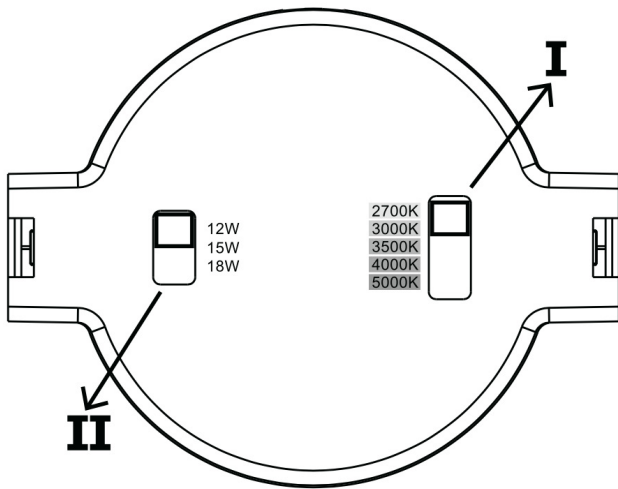

**SWITCH I** Selectable CCT  
2700K / 3000K / 3500K / 4000K / 5000K

**SWITCH II** Selectable Power  
-4-inch Selectable: 8W / 10W / 12W  
-6-inch Selectable: 12W / 15W / 18W

**SAVE THESE INSTRUCTIONS**