



DUNTON HOUSE

DECORATIVE LIGHTING

CLARK-WL EXTERIOR SCONCE E26/LED

PROJECT DATE

COMMENTS



PHYSICAL

Material	Metal
Lens Material	E26: Clear Glass LED: Opal Glass
Mounting	Wall Mounted
Finish	Black
Source	E26: 1 x E26, (Lamp Not Included), Decorative A15, B, and G Shapes Recommended. Do not use A19 Shape, it will not fit inside glass shade. LED: 12W Integrated LED
Dimensions	W 6" x D 8" x H 13"

PERFORMANCE

Warranty	5 years
Certification	cETLus, Wet Location
Rated Life	LED: L70 > 50,000 hours
CCT	LED: 3000K
CRI	LED: 80CRI
Delivered Lumens	LED: 600

ELECTRICAL

Wattage	E26: 60W Type A Maximum Per Socket LED: 12W
Voltage	120V
Dimmable	Yes, with dimmable lamp and dimmable switch. Dimmable lamp and dimmable switch not included.



WITH E26 SOURCE



WITH LED SOURCE

DIMENSIONAL DATA

HEIGHT inches	WIDTH inches	DEPTH inches
13	6	8

NOTES

Usage	Indoor Only
-------	-------------

ORDERING LOGIC

EX: CLARK-WL-E26

FAMILY	TYPE	SOURCE
CLARK	WL	
	WL Wet Location Exterior Sconce	E26 E26 LED LED



DIMENSIONS

CLARK-WL-E26

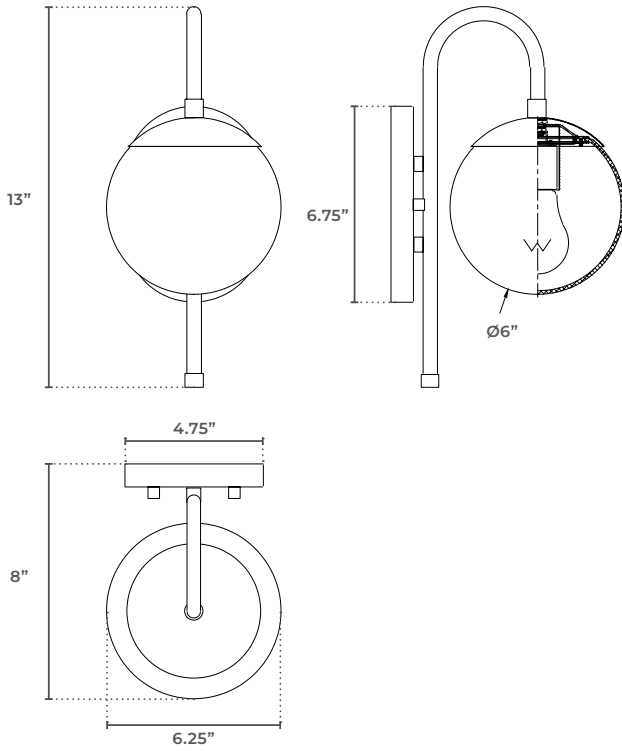

CLARK-WL-LED

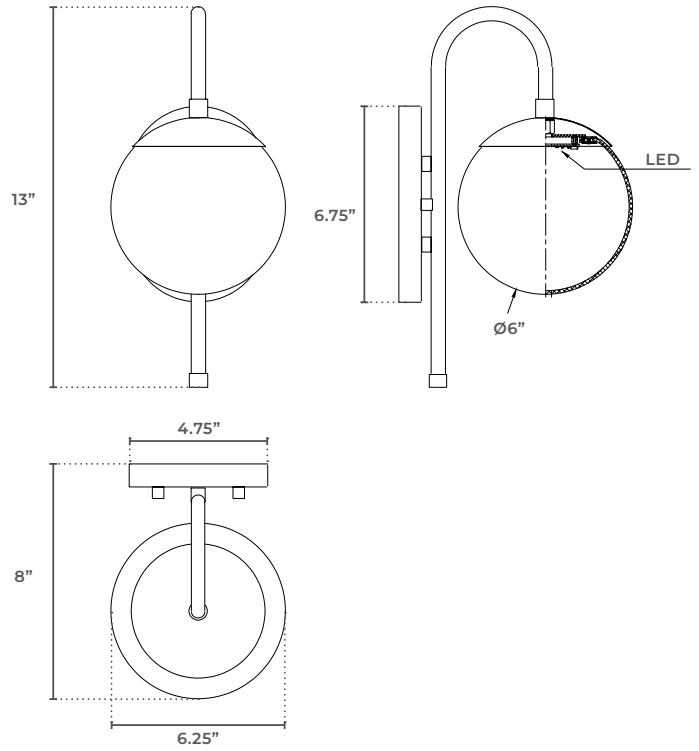

CLARK FAMILY

CLARK-1
VANITY E26



CLARK-2
VANITY E26



CLARK-3
VANITY E26



CLARK-4
VANITY E26



CLARK-C
CHANDELIER E26 CHAIN + STEM



CLARK-MP
MINI PENDANT E26 CABLE + STEM

