

PROJECT _____ DATE _____

COMMENTS _____



RWC-G3 ROUND WALL CYLINDER LED DIRECT GEN 3

The RWC-G3 Series is an outdoor decorative, round, high output wall mount fixture with direct LED light distribution.

- Residential
- Commercial
- Hospitality

PHYSICAL

Material	Die-Cast Aluminum Housing
Mounting	Wall Mount
Lens	Acrylic
Finish	Powder Coated: Black, Bronze, White, Gray

PERFORMANCE

Warranty	5 years
Certifications	Wet Location, ETL
IP Rating	IP65
Rated Life	≥50,000 hours
Operating Temperature	0°C to 50°C (32°F to 122°F)
THD	<20% at full load
CCT	Field Selectable: (2700K/3000K/3500K/4000K/5000K)
CRI	80+
Beam Angle	60°

ENERGY CHART

HEIGHT inches	DIAMETER inches	DELIVERED LUMENS	WATTAGE	EFFICACY lm/w
8.39	4.3	700	7	100
		1000	10	100
		1300	13	100

ELECTRICAL

Wattage	Field Selectable (7W/10W/13W)
Voltage	110-277V AC
Power Factor	>0.9 at full load
Dimming	0-10V

ORDERING LOGIC

EX: RWC-G2-FS-BK

FAMILY	CCT	FINISH	OPTIONS
RWC-G3	FS		
	FS Field Selectable <small>2700K / 3000K / 3500K / 4000K / 5000K</small>	BK Black BZ Bronze WH White GR Gray	EM 4W Emergency Battery Backup PC Photocell



DIMENSIONS

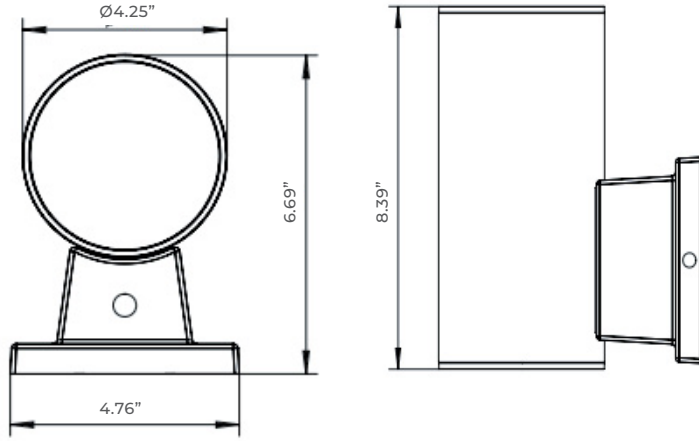

FIELD SELECTABLE FUNCTIONS

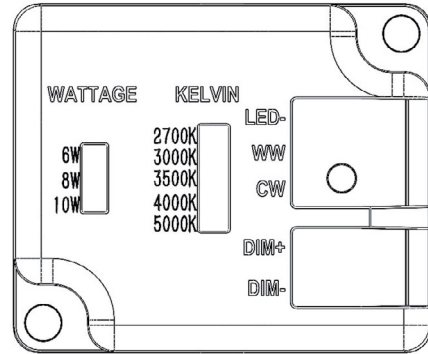

ADDITIONAL IMAGERY

