



IMPORTANT SAFETY PRECAUTIONS

Before you begin, read these instructions completely and carefully.

- Be certain electrical power is OFF before and during installation, maintenance and removal.
- Luminaire wiring must be properly grounded in accordance with the NEC and any applicable local code requirements.
- Use only UL or IEC approved wire for input/output connections.
- Verify that supply voltage matches voltage on luminaire label. Installation to any other connection may void the warranty.
- Wear gloves during installation to prevent injury and do not expose wiring to metal or sharp edges.
- Do not install in areas subject to combustible vapors or gases. Verify luminaire location ratings are suitable for installation environment (refer to specification sheet as needed).
- Do not restrict luminaire's ventilation by covering with material that will cause luminaire to overheat and potentially shorten the life span.
- Ensure LED luminaire has the correct polarity before installation.



WARNING: To reduce the risk of personal injury or property damage from fire, electrical shock, falling parts, abrasions, burns and all other hazards, read all provided warnings and follow installation instructions.

This product should be installed, inspected and maintained by a qualified and licensed electrician. Installation of luminaire must be in accordance with NEC and local code requirements.

SAVE THESE INSTRUCTIONS



DIMENSIONS

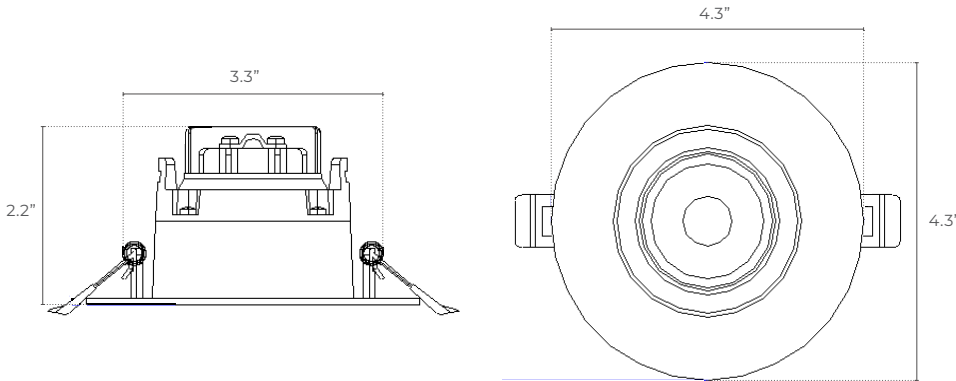

REMOTE DRIVER DIMENSIONS

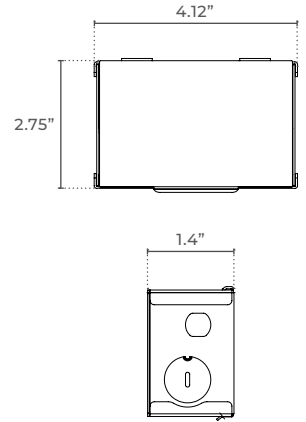

INSTALLATION INSTRUCTIONS

Turn power OFF from the electrical panel prior to installation.

A) Determine the location for installation and cut ceiling hole in accordance with cut-hole dimensions.

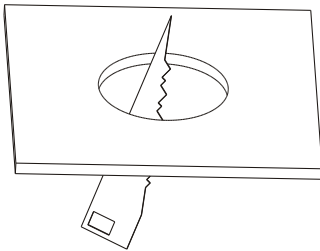

ROUND	Hole Size
2 inches	Ø 2.04"
3 inches	Ø 3.25"
4 inches	Ø 4.25"

B) Open the junction box cover and remove the appropriate knockout(s) on the side panel. Insert the electrical supply cable through the knockout and secure with a cable connector (sold separately). Using quick-connect push-in terminals, connect the ground wire to the green wire terminal; black wire to black wire terminal; white wire to white wire terminal.

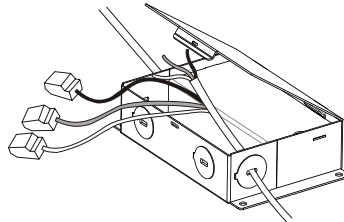

C) Place all wiring and connections back into the box and close the cover. Connect the driver to the light panel. Insert junction box through the mounting hole.

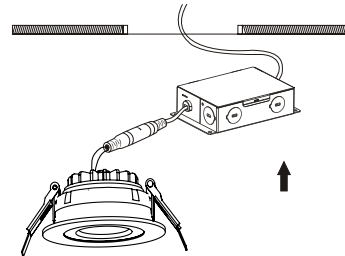

D) Push spring-loaded clips on the fixture upwards and insert fixture base into the mounting hole. Release the clips and fixture will be pulled flush to the ceiling. Finish the installation.

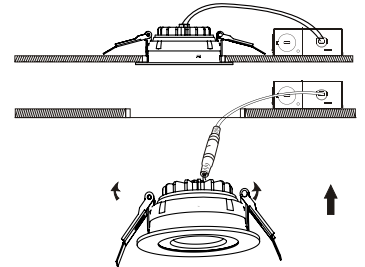

DIMMING

This product is compatible with most residential type dimmers available on the market. The dimming performance will depend on kind of dimmer and dimmer settings.

Search the dimmer information on: <http://store.leviton.com/such as DSL06-1LZ>. <http://www.lutron.com/such as SS-600P-A> Dimming Range: 20% to 100%

COMPATIBLE DIMMERS

- Lutron(DV-603P)
- Leviton(DSL06)

SAVE THESE INSTRUCTIONS

