

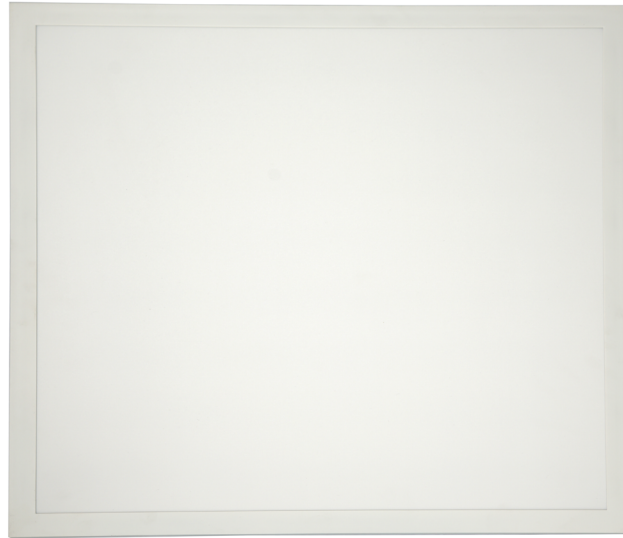

RoHS
Compliant



IMPORTANT SAFETY PRECAUTIONS

Before you begin, read these instructions completely and carefully.

- Be certain electrical power is OFF before and during installation, maintenance and removal.
- Luminaire wiring must be properly grounded in accordance with the NEC and any applicable local code requirements.
- Use only UL or IEC approved wire for input/output connections.
- Verify that supply voltage matches voltage on luminaire label. Installation to any other connection may void the warranty.
- Wear gloves during installation to prevent injury and do not expose wiring to metal or sharp edges.
- Do not install in areas subject to combustible vapors or gases. Verify luminaire location ratings are suitable for installation environment (refer to specification sheet as needed).
- Do not restrict luminaire's ventilation by covering with material that will cause luminaire to overheat and potentially shorten the life span.
- Ensure LED luminaire has the correct polarity before installation.



WARNING: To reduce the risk of personal injury or property damage from fire, electrical shock, falling parts, abrasions, burns and all other hazards, read all provided warnings and follow installation instructions.

This product should be installed, inspected and maintained by a qualified and licensed electrician. Installation of luminaire must be in accordance with NEC and local code requirements.

SAVE THESE INSTRUCTIONS

DIMENSIONS

1 X 4

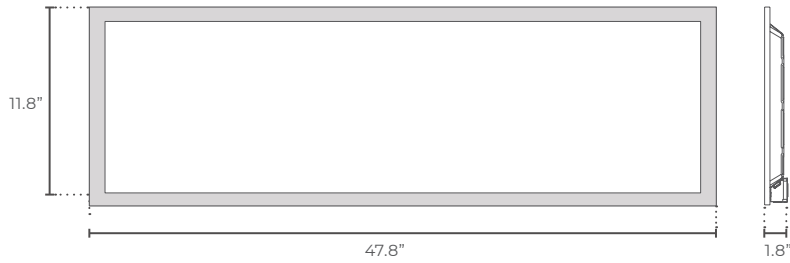

2 X 2

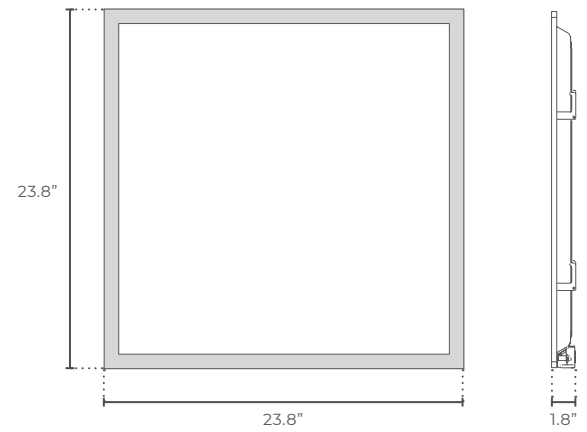

2 X 4



MOUNTING TYPE

Recessed Mount

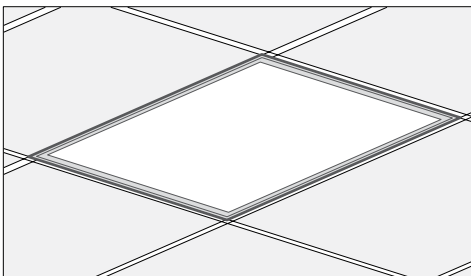

Surface Mount

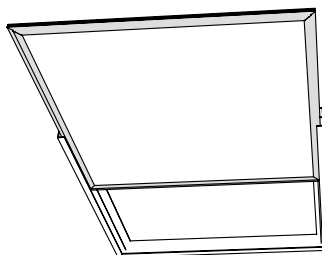

Suspended Mount

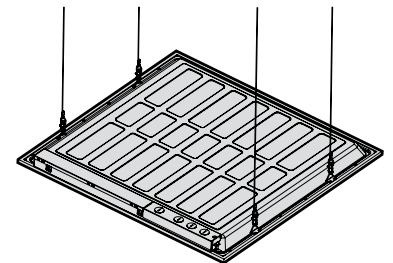

SAVE THESE INSTRUCTIONS

ELECTRICAL CONNECTIONS

A) Open the junction box.

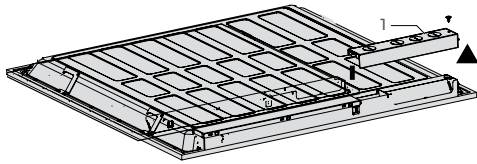

Unscrew and remove the junction box cover (1) from the fixture.

B) Connect the supply wires.

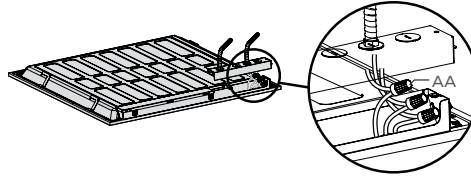

Connect the green ground wire from the fixture to the supply ground wire.

Connect the white wire from the fixture to the supply white wire (neutral wire).

Connect the black wire from the fixture to the supply black wire (live wire).

Secure the three connections using three wire nuts (AA).

Wrap the three wire connections with electrical tape for a more secure connection (electrical tape not included).

C) Connect the dimming wires.

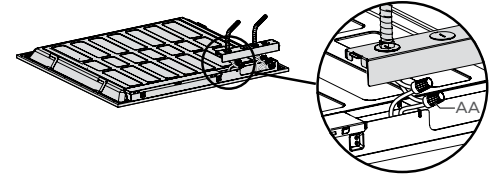

Connect the purple wire from the fixture to the purple (DIM+) supply wire.

Connect pink wire from fixture to pink (DIM-) supply wire.

****NOTE:** If supply wire has not been updated per new NEMA requirement, DIM- wire maybe gray.

Secure the two connections using the remaining two supplied wire nuts (AA).

Wrap the two wire connections with electrical tape for a more secure connection (electrical tape not included).

D) Reinstall the junction box.

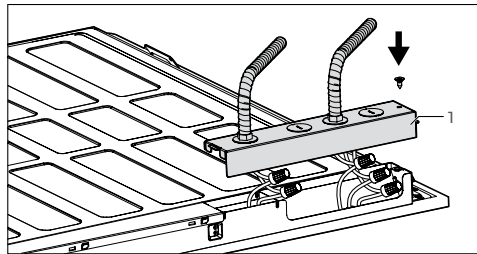

Position the wires back inside the junction box.

Reinstall the junction box cover (1). Secure the screw.

RECESSED MOUNT INSTRUCTIONS

A) Remove the grid tile from the ceiling.

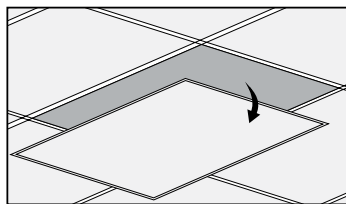

B) Lift the fixtures into the ceiling and connect the wires.

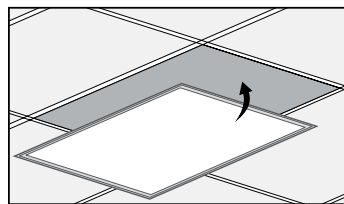

C) Adjust the CCT and wattage.

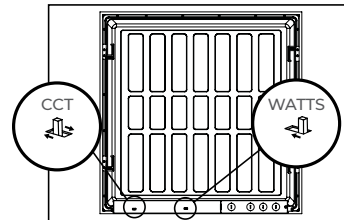

D) Place the fixture into the ceiling grid and attach the earthquake clips by the bending over the grid rails.

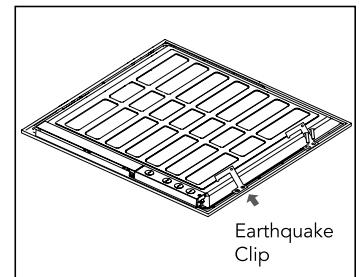

SAVE THESE INSTRUCTIONS

SURFACE MOUNT INSTALLATION

A) Assemble the four sides with Screw A (8 total) to create the frame.

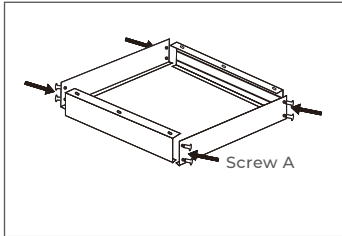

B) Fix the frame to the ceiling with Screw B fitting into Expansion Bolts.

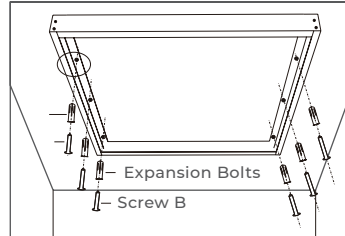

C) Once securely mounted to the ceiling, disassemble one end by removing Screw A (4 total).

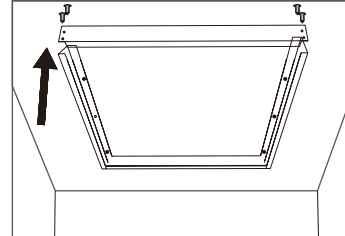

D) Slide the panel into the frame channel.

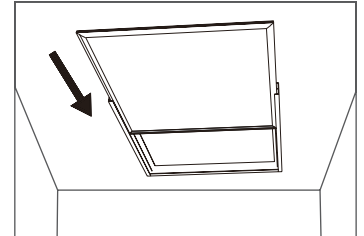

E) Reassemble the remaining end with Screw A (4 total).

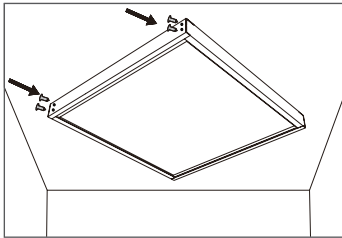

SUSPENDED MOUNT INSTALLATION

A) Based on the length of the panel, drill two mounting holes on the mounting plane. (2 holes for 2-cable kit and 4 holes for 40-cable kit).

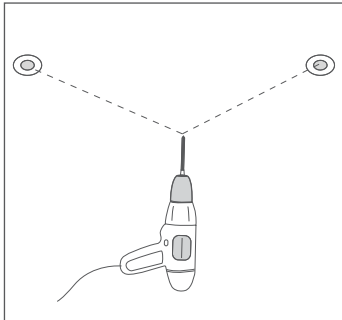

B) Fix upper cover to mounting hole.

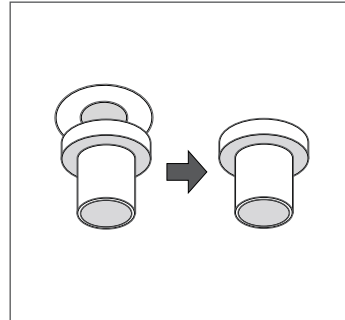

C) Insert Screw B into the Expansion Bolt to create self-tapping screw.

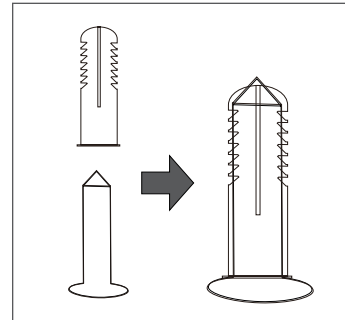

D) Use the self-tapping screw to secure the upper cover to the mounting hole.

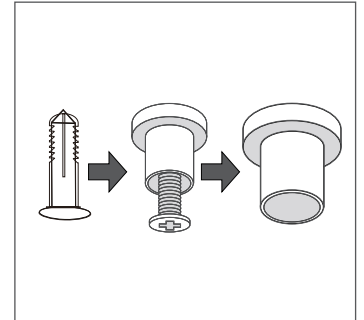

E) Screw the lower cover into the upper cover. Connect the wires with suspension hooks to the lower covers.

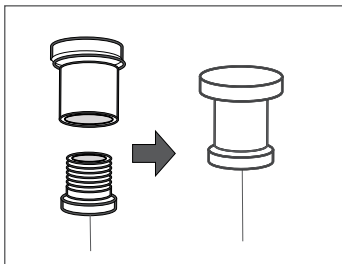

F) Replace earthquake clips with triangle brackets (use existing screws to secure).

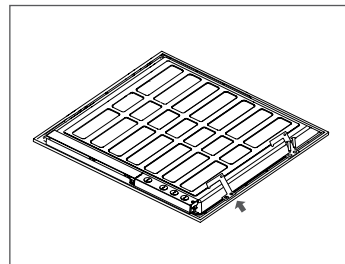

G) Release wire and attach suspensions hooks to triangle brackets. Adjust wires to desired length.

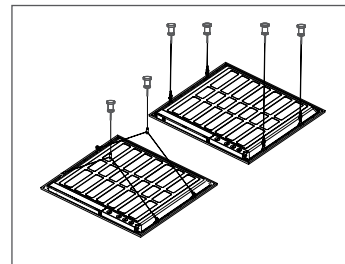

SAVE THESE INSTRUCTIONS