

IMPORTANT SAFETY PRECAUTIONS

Before you begin, read these instructions completely and carefully.

- Be certain electrical power is OFF before and during installation, maintenance and removal.
- Luminaire wiring must be properly grounded in accordance with the NEC and any applicable local code requirements.
- Use only UL or IEC approved wire for input/output connections.
- Verify that supply voltage matches voltage on luminaire label. Installation to any other connection may void the warranty.
- Wear gloves during installation to prevent injury and do not expose wiring to metal or sharp edges.
- Do not install in areas subject to combustible vapors or gases. Verify luminaire location ratings are suitable for installation environment (refer to specification sheet as needed).
- Do not restrict luminaire's ventilation by covering with material that will cause luminaire to overheat and potentially shorten the life span.
- Ensure LED luminaire has the correct polarity before installation.



WARNING: To reduce the risk of personal injury or property damage from fire, electrical shock, falling parts, abrasions, burns and all other hazards, read all provided warnings and follow installation instructions.

This product should be installed, inspected and maintained by a qualified and licensed electrician. Installation of luminaire must be in accordance with NEC and local code requirements.

SAVE THESE INSTRUCTIONS



HARDWARE INCLUDED

NOTE: Hardware not shown to actual size.

PART	DESCRIPTION	QUANTITY
AA	Mounting bracket	1
BB	Mounting screw	2
CC	Wire nut	3

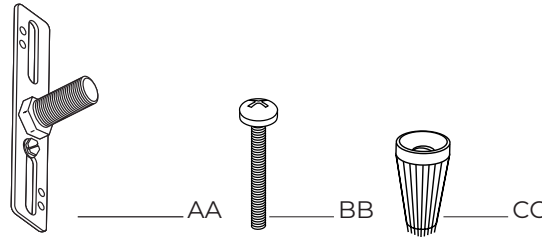

PACKAGE CONTENTS

PART	DESCRIPTION	QUANTITY
A	Light fixture	1
B	Socket ring	3
C	Shade	3

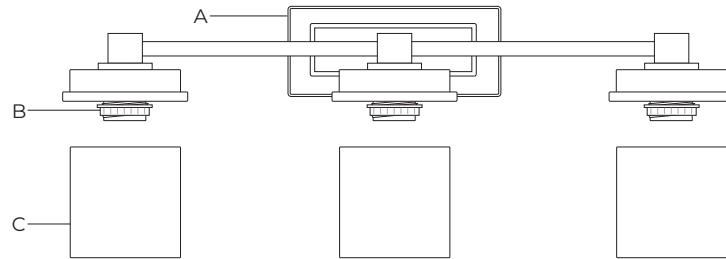

INSTALLATION INSTRUCTIONS

1) Attaching the mounting bracket to the junction box

- Remove the preinstalled cap nut from the mounting unit (AA) and put it in a safe location.
- Attach mounting unit (AA) to the junction box (not included) with mounting screws (BB).

NOTE: The preinstalled support screws on the mounting unit (AA) should protrude out away from the junction box.

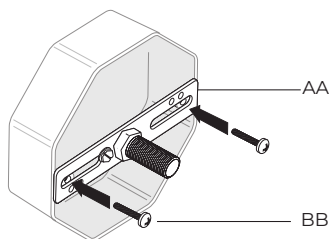

2) Making the electrical connections

- Connect the copper wire on the light fixture (A) to the mounting bracket (AA) by securing it with the preinstalled ground screw.
- Connect the black to black (power), the white to white (neutral) and copper wire to ground wire with the wire nuts (CC) and secure with electrical tape (not included).

NOTE: If the wires from the fixture are the same color, attach the side with markings or letters to the black (positive) wire and the other to the white (neutral) wire.

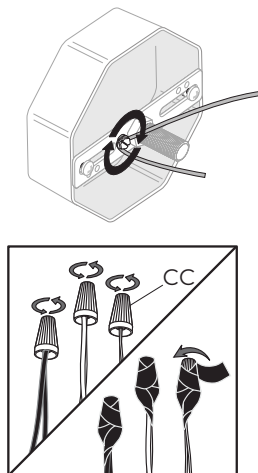

3) Securing the light fixture

- Secure the light fixture (A) to the junction box by placing it over the preinstalled pipe nipple on the mounting unit (AA) and securing with the previously removed cap nut.
- Remove the preinstalled socket ring (B), add shade (C) and re-secure the socket ring (B).

NOTE: Light fixture (A) can be installed with the socket facing either up or down.

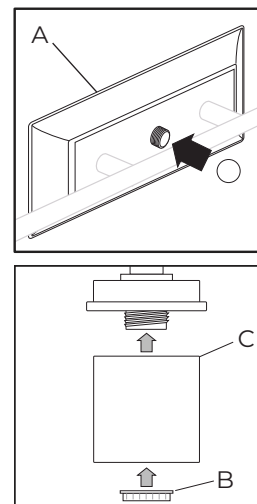

4) Installing the light bulbs

- Install three 60-watt max. medium-base incandescent bulbs or three 13-watt max. CFL bulbs (none included).

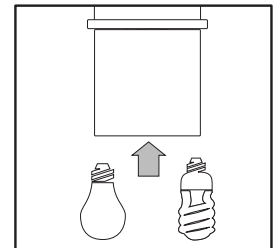

SAVE THESE INSTRUCTIONS

